

Drain: WILLIAM KRAUSE **Drain #:** 267
Improvement/Arm: _____
Operator: J. LIVINGSTON **Date:** 2-25-04
Drain Classification: Urban/Rural **Year Installed:** 1920

GIS Drain Input Checklist

- Pull Source Documents for Scanning _____ *JWJ*
- Digitize & Attribute Tile Drains _____ *JWJ*
- Digitize & Attribute Storm Drains _____
- Digitize & Attribute SSD _____
- Digitize & Attribute Open Ditch _____
- Stamp Plans _____ *JWJ*
- Sum drain lengths & Validate _____ *JWJ*
- Enter Improvements into Posse _____
- Enter Drain Age into Posse _____ *JWJ*
- Sum drain length for Watershed in Posse _____ *JWJ*
- Check Database entries for errors _____ *JWJ*

**Gasb 34 Footages for Historical Cost
Drain Length Log**

Drain-Improvement: WILLIAM KRAUSE

Drain Type:	Size:	Length	Length (DB Query)	Length Reconcile	If Applicable	
					Price:	Cost:
TILE	8"	478'	478'		2. ⁰⁰ /lf	956. ⁰⁰
	12"	462'	462'		4. ⁰⁰ /lf	1848. ⁰⁰
	15"	50'	50'		5. ⁰⁰ /lf	250. ⁰⁰
	18"	250'	250'		6. ⁵⁰ /lf	1625. ⁰⁰
	21"	90'	90'		9. ⁰⁰ /lf	810. ⁰⁰
	24"	3985'	3985'		11. ⁰⁰ /lf	43835. ⁰⁰
TILE - ARM 1	6"	66'	66'		1. ⁰⁰ /lf	66. ⁰⁰
TILE - ARM 2	6"	165'	165'		1. ⁰⁰ /lf	165. ⁰⁰
TILE - ARM 3	8"	660'	660'		2. ⁰⁰ /lf	1320. ⁰⁰
TILE - ARM 4	18"	50'	50'		6. ⁵⁰ /lf	325. ⁰⁰

Sum: 6256' 6256' \$51,200.⁰⁰

Final Report: _____

Comments:

IN THE MATTER OF THE
PETITION OF THE
TOWN OF SHERIDAN, et al
FOR THE ALTERATION AND
REPAIR OF THE
KRAUSE TILE DRAIN

CAUSE NO. A9280

FILED

MAY 7 - 1953

Clarence DeVaney
Clerk Hamilton Circuit Court

*Set for hearing on
June 15 - 1953*

*Submitted to Howard
Hearland*

Mitchell cards

Submitted May 12 - 1953

STATE OF INDIANA }
COUNTY OF HAMILTON) ss:

IN THE HAMILTON CIRCUIT COURT
APRIL TERM, 1952

IN THE MATTER OF THE PETITION
OF THE TOWN OF SHERIDAN, et al
FOR THE ALTERATION AND REPAIR
OF THE KRAUSE TILE DRAIN

CAUSE NO. A9280

The report of the viewers was favorable and was filed.

Report of R. D. Horney, County Surveyor, who was appointed to supervise the construction of above drain, would respectfully report that he has made a survey of the above drain and did proceed and definitely determine the best and cheapest method of drainage, the terminal and route, location, character of the proposed work, and fix the same by notes and bounds, courses and distances and descriptions, including grades and bench marks, including all necessary areas, estimated the cost thereof, divided the drain or ditch into sections of not more than one hundred feet in length, and computed and set out the number of cubic yards of excavation in each section, assessed the benefits of damages as the case may be, to each separate tract of land in the water shed to be affected thereby and to easements held by railways or other public or private corporations, or towns, including any land rights, easements, or water power, injuriously or beneficially affected, and do make report to the court under oath.

LOCATED near Indiana Condensed Milk Company plant at Sheridan, Adams Township, Hamilton County, Indiana. Commencing at the Northwest corner of Park Avenue and State Road #17, or 10th Street, in town of Sheridan, construct man hole and open inlet connection over the old Krause tile drain; thence South across State Road #17, or

The estimate has been made and cost divided equally among the different lands and County Highways of Hamilton County, affected. The assessment sheet attached, attorneys fees, court cost, incidentals, viewers, engineers, helpers, mileage, stakes and superintendent of construction.

R. D. Horney or his authorized assistant will have full charge of the work and no work shall be changed or deviated from without his approval.

STATE OF INDIANA)
) SS:
HAMILTON COUNTY)

I, the undersigned engineer to whom was referred the above entitled petition for construction, after being duly appointed say that I have personally examined the whole line of proposed ditch, that the assessments herein made are correct, just and equitable to all concerned herein as interested, that no lands will be benefited or injured by said proposed drain and that the above and foregoing report is true in substance and in fact as I verily believe.

R. D. Horney
R. D. Horney, Registered Engineer

Approved _____

Subscribed and sworn to before me this 6 day of May, 1953.

L. Rue Wallace

Walter Pritsch

Viewers

Notary Public

My Commission Expires

Clarence D. Diney
Clerk of the Hamilton
Circuit Court

Authority
Section 9 -- page 1174 - 1175
Acts of Indiana General Assembly 1933.

10th Street with 15" reinforced concrete pipe approximately 50 lin. ft. to near South R/W line of said road, or street. Then construct man hole and open inlet for flood water from West. Thence East on or along said South R/W line 250.0 feet with 18" reinforced concrete pipe to West side of Mallott Street. Construct 18" open inlet for water from street from the South. Thence East 50 lin. ft. to East side of Mallott Street with 21" reinforced concrete pipe construct man hole or junction box with 18" open tile inlet connecting with box and pipe going under road North to man hole and main Krause ditch.

Clean out pipe under road.

Standard man holes with inlets as per approval of Engineer.

The two inlets in Park Avenue to be inspected, repaired, and connected to new man hole - where tile crosses State Road #47. The ditch to be filled with gravel to approval of State Highway Inspector.

The concrete across Road to be cut approximately 18" wider on each side of ditch before concreting pavement.

When pavement is concreted the mix to be extra rich, or quick setting cement; with heavy wire mesh in concrete.

All work to be done in a neat and workmanlike manner.

Quantities for Kraus Drain

- 50 lin. ft ^{15"} ren. concrete pipe
- 250 + or - 18 " reinforced pipe
- 50 + or - 21 " " "
- 1 large M.H. complete
- 2 Standard M.H. "
- 4 inlets complete
- 1 21 " / 15 " Tee
- 1 15" Ell.

open inlets to be 36" reinforced pipe with connection to pipe.

2468
12340
12340

Henry Darnan

July 2, 1953

Profile of Krauss Drain.

Sta	Top Stake	to flow line
	Cut	
Stake 0	5.77	
0+50	+50	6.49
1		7.37
+50		7.56
2		6.52
+50		6.49
3		6.17
+40		7.76

R e s u m e

3	man holes complete	\$ 800.00
3	open inlets complete	150.00
50	lin. ft. + / - 15" reinforced concrete pipe	90.00
250	lin. ft. + / - 18" reinforced concrete pipe	462.00
50.0	lin. ft. + / - 21" reinforced concrete pipe	116.00
	Extra expense cross #17	150.00
	Excavating, laying tile, and back fill	600.00
	Miscellaneous	350.00
	Engineer and Supervision	<u>200.00</u>

\$ 2,918.00

2918.00

diagonal 10/0-
 amended assessment

Amended Assessment
 Dated June 23
 (SHERIDAN)

KRAUSE DRAIN

NAMES	DESCRIPTION OF LANDS		Section	Township	Range	Acres Assessed		Acres Benefitted		Amount Of Benefits		Amount of Assessment		Total Assessment	
						A	Hun	A	Hun	\$	Cts.	\$	Cts.	\$	Cts.
Lloyd Wills	Pt W $\frac{1}{2}$	NW NW	5	19	3	12	00	82 20 88 20				111 00			
<i>Sheridan</i>	Pt W $\frac{1}{2}$	NW NW	5	19	3	2	48	18	19	106	39	29 76		299 76	
										100	37				
Van E. Miller	Pt NE	NW	5	19	3	7	64	52	67			94 68			
<i>Sheridan</i>	Pt NW	NW	5	19	3	15	80	108	42			109 60			
	Pt E $\frac{1}{2}$	NW	5	19	3	6	00	41	36			72 00			
	Pt NE	NW	5	19	3	3	00	20	66			35 00			
	{ Out lot { Pt NE	B-B NW	5	19	3	2	36	16	24	23	06	28 32			
	Pt NW	NW	5	19	3	1	70	11	71	25 06		20 10		150 00	
Maggie Fox	Pt NW	NW	5	19	3	6	00	64	80	64	80	70 00		70 00	
<i>Sheridan</i>															
Arthur Barker	Pt NE SW	NW	5	19	3	6	00	64	80	64	80	70 00		70 00	
<i>Sheridan</i>															
Lon J. Singleton	Pt E	SW	32	20	3	1	33	31	50	31	50	35 00		35 00	
<i>Sheridan</i>															
Fred & Esther Holliday Pt		SW	32	20	3		60	20	70	20	70	23 00		23 00	
<i>Sheridan</i>															
Lisle Wallace	Pt SE	SW	32	20	3	1	00	63	00			70 00			
	Pt SW	SW	32	20	3		50	18	00			20 00			
	Pt S.	SW	32	20	3		91	63	00	149	00	70 00		100 00	
Levi Wallace	Pt SE	SW	32	20	3		56	31	50	31	50	35 00		35 00	
<i>Sheridan</i>															
Indiana Gas & Water Co.	Pt SE	SW	32	20	3	1	00	45	00	45	00	50 00		50 00	
State Hy #17								135	00	135	00	150 00		150 00	
Indiana STATE Highway REENFIELD Office <i>Ind.</i>												240 75		240 75	
												868	75		

Amended Assessment

KRAUSE DRAIN

(SHERIDAN)

NAMES	DESCRIPTION OF LANDS	Section	Township	Range	Acres Assessed		Acres Benefited		Amount Of Benefits		Amount of Assessment		Total Assessment	
					A	Hun	A	Hun	\$	Cts.	\$	Cts.	\$	Cts.
Clayton Van Meter	Pt W. SW	32	20	3	10-19-58		25	16 20	16	20	32 00	32 00		
Wm Agers	Pt w. SW	32	20	3		20	12 60	12 60			24 00	24 00		
Indiana Condensed Milk Co. Sheridan.	Pt S. SW	32	20	3	2	58	1250 00	1250 00			700 00	700 00		
G. I. & L. R. R. Sheridan	Benefit to R/W	32	20	3			14 40	14 40			28 00	28 00		
<u>A. SMITH 2nd ADDITION TO SHERIDAN</u>														
Ross D. Pearson	Lot #1						7 20	7 20			8 00			
Robert Mann	Lot #2						7 20	7 20			8 00	30 00		
Everett Mace	Lot #3						7 20	7 20			8 00	30 00		
Clarence Reddick	Lot #4						7 20	7 20			8 00	30 00		
Willie Boyer	Lot #5						7 20	7 20			8 00	30 00		
Robert Seats	Lot #6						7 20	7 20			8 00	30 00		
JOHN E. CRIST. Thos. P. Gurn	Lot #7						7 20	7 20			8 00	30 00		
Robert Goodner	Lot #8						7 20				8 00			
	Lot #9						7 20				8 00			
	Lot #10						7 20				8 00			
	Lot #11						7 20				8 00			
	Lot #12						7 20	36 00			8 00	40 00		
											811 00	811 00		

137960

Amended Assessment

K R A U S E

D R A I N

(SHERIDAN)

NAMES	DESCRIPTION OF LANDS				Section	Township	Range	Acres Assessed		Acres Benefitted		Amount Of Benefits		Amount of Assessment		Total Assessment	
								A	Hun	A	Hun	\$	Cts.	\$	Cts.	\$	Cts.
	<u>THISTLEWATE</u>							<u>2nd</u>		<u>ADDITION</u>							
William H. Teter <i>Sherridan</i>	Lot 1	Block 4							20	70	20	70	22	00	22	00	
Charles Keeling <i>Sherridan</i>	Lot 2	Block 4							20	70	20	70	22	00	22	00	
Lewis Millikan <i>Sherridan</i>	Lot 6	Block 4							20	70	20	70	22	00	22	00	
Ben Hoffman <i>Sherridan</i>	Lot 7	Block 4							20	70	20	70	22	00	22	00	
Mary Osborn <i>Sherridan</i>	Lot 8	Block 4							20	70	20	70	22	00	22	00	
Lewis C. Mitchell <i>Sherridan</i>	Lot 1	Block 5							20	70	20	70	22	00	22	00	
Owen Pettijohn <i>Sherridan</i>	Lot 2	Block 5							20	70	20	70	22	00	22	00	
Ralph S. Baker <i>Sherridan</i>	Lot 3	Block 5							20	70	20	70	22	00	22	00	
Mina Hall <i>Sherridan</i>	Lot 4	Block 5							20	70	20	70	22	00	22	00	
Robert Boyless <i>Sherridan</i>	Lot 5	Block 5							20	70	20	70	22	00	22	00	
Ralph Bush <i>Sherridan</i>	Lot 6	Block 5							20	70	20	70	22	00	22	00	
Chester E. Mace <i>Sherridan</i>	Lot 7	Block 5							20	70	20	70	22	00	22	00	
Lloyd Wallace <i>Sherridan</i>	Lot 8	Block 5							20	70	20	70	22	00	22	00	
William Rood <i>Sherridan</i>	Lot 7	Block 6							20	70	20	70	22	00	22	00	
																	289 80 22 00

Amended Assessment

KRAUSE

DRAIN

(SHERIDAN)

NAMES	DESCRIPTION OF LANDS	Section	Township	Range	Acres Assessed		Acres Benefited		Amount Of Benefits		Amount of Assessment		Total Assessment	
					A	Hun	A	Hun	\$	Cts.	\$	Cts.	\$	Cts.
	SHERIDAN													
	GLASS & MFG. CO. ADDITION													
Indiana Condensed Co.	Lot 3							540				6.00		
<i>Sheridan</i>	Lot 4							540	1080			6.00		12.00
Fred Burton	Lot 9							540				6.00		
<i>Sheridan</i>	S ¹ / ₂ " 38 S ¹ / ₂ " 53							540 270		1350		6.00 6.00		12.00
James W. Jones	<i>see map of Sheridan</i>													
Roland G. Poland	Lot 10							540	540			6.00		6.00
<i>Noblesville</i>														
Lawrence Whicker	Lot 15							540	540			6.00		6.00
<i>Sheridan</i>														
Letha B. Knight	Lot 8							540				6.00		
<i>Sheridan</i>	Lot 2							540				6.00		
	Lot 5							540	1620			6.00		18.00
Mattie Weatherford	Lot 11							540	540			6.00		6.00
<i>Sheridan</i>														
Peter Glenn	Lot 14							540	540			6.00		6.00
<i>Sheridan</i>														
William Agers	Lot 20							540				6.00		
<i>Sheridan</i>	Lot 21							540	1080			6.00		12.00
Willis Parks	Lot 28							540				6.00		
<i>Sheridan</i>	Lot 29							540				6.00		
	Lot 36							540	1620			6.00		18.00
									8910			57.00		67.00

Assessment

KRAUSE DRAIN

(SHERIDAN)

NAMES	DESCRIPTION OF LANDS	Section	Township	Range	Acres Assessed		Acres Benefited		Amount Of Benefits		Amount of Assessment		Total Assessment	
					A	Hun	A	Hun	\$	Cts.	\$	Cts.	\$	Cts.
	A. SMITH	End												
Julius Glenn	Lot 13				7 20		7 20							
<i>Shundan</i>	Lot 14				7 20		7 20							
	Lot 15				7 20		7 20	21 60						
Eva Emry	Lot 16						7 20	7 20						
<i>Shundan</i>														
Wiley Carpenter	Lot 17						7 20	7 20						
<i>Shundan</i>														
Nettie Six	Lot 18						7 20	7 20						
<i>Shundan</i>														
Nettie Buzan	W 1/2 Lot 19						3 60							
<i>Shundan</i>	W 1/2 Lot 20						3 60	7 20						
John F. Kelmath	E 1/2 Lot 19						3 60							
<i>Shundan</i>	E 1/2 Lot 20						3 60	7 20						
								57 60						
	Acres	74.39												
	Lots	67												
	Page 1	4					894 75			868 75				
	Page 2	5					1379 60			1379 60				
	Page 3	6					289 80			289 80				
	Page 4	7					233 15			233 15				
	Page 5	8					89 10			89 10				
	Page 6	9					57 60			57 60				
	TOTAL						2954 85			2918 00				Final



This information was gathered for input into the Hamilton County Geographical Information System. This document is considered an official record of the GIS.

Entry Date: 2-25-04

Entered by: [Signature]



PARK 40' AVE.

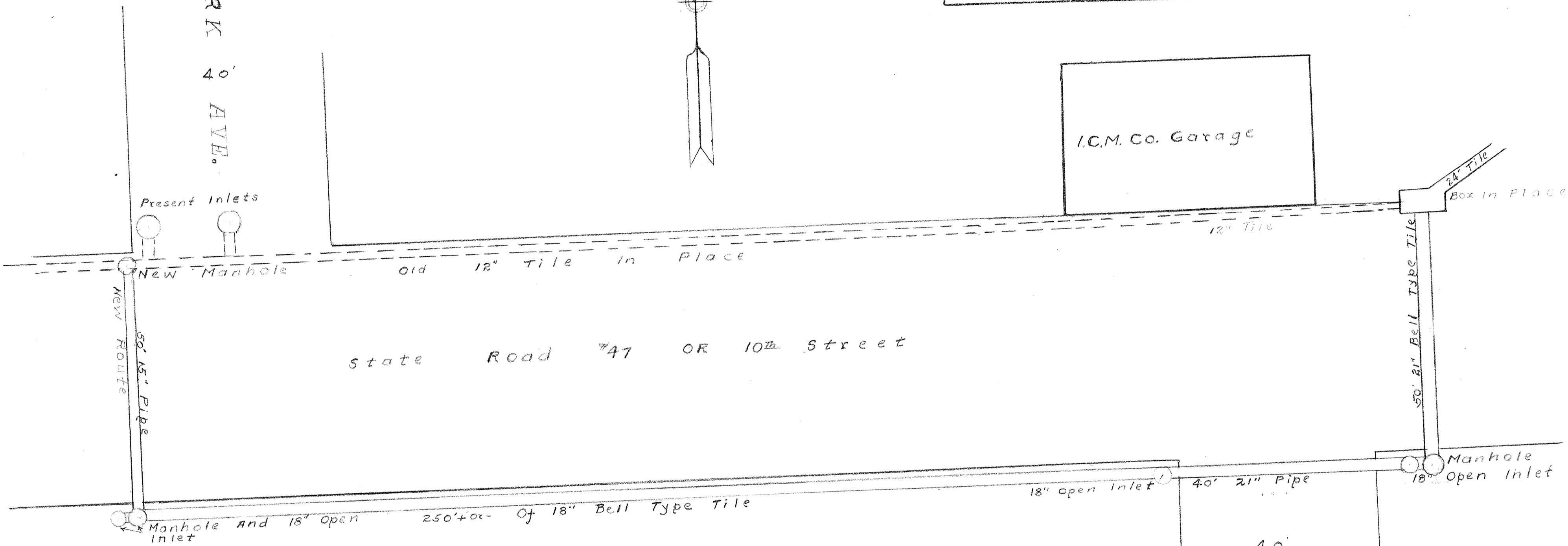
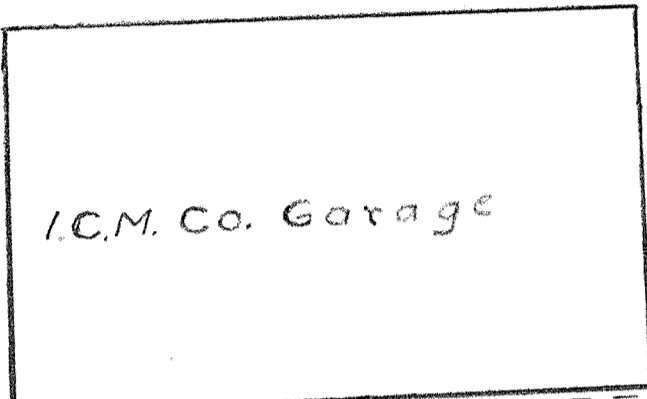

40' MHILOT T AVE

18823

In the matter of
Wm Krause et al. vs. Train

FILED

(Record)

JUL 16 1920

J. D. Hill

CLERK OF SUPERIOR COURT

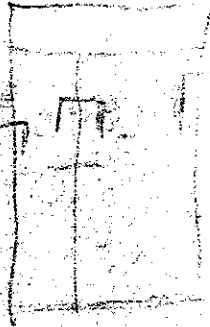

18823

STATE OF INDIANA }
HAMILTON COUNTY } SS

IN HAMILTON *Circuit* COURT.

IN THE MATTER OF THE PETITION *of William Krause et al*
OF
FOR DRAINAGE

Report of the Drainage Commissioners and the Engineer,
To the honorable *Judge of the Circuit Court of Hamilton County.*
We the undersigned Commissioners of Drainage and the Engineer, to
whom the above entitled petition for drainage of certain lands, in
Adams, Hamilton County, Indiana, was referred:

We would respectfully report that we met on the line of the
said proposed repair of said *Wm Krause*, drain, on the
18th day of *Aug.* 1919, qualified and proceeded to view said
drain and lands affected thereby.

After a careful investigation of the conditions of said drain
we are of the opinion that said drain should be repaired, and in the
manner set out below in ~~these~~ ~~these~~ this report and that the same
when completed will improve the public health and will benefit cer-
tain highways, also that the cost of construction and repair, damages
and expense of effecting said drainage will be less than the benefits
to the lands effected by said drainage.

That we have definitely determined the best and cheapest
method of effecting the drainage of such lands, we have fixed the
route, location, and character of said proposed work and have fixed
the same by metes and bounds, courses, distances, descriptions and
guides, and bench marks, including arms and branches so as to pre-
vide for a complete outlet for the drainage of said lands effected
by said proposed work; that we have divided the ditch and branches
into sections of not more than 100 feet in length by setting stakes
at each 100 feet.

76

LOCATION.

MAIN DITCH: Begin at a point 15 feet north of the center line of 10th St at the center line of the first alley west of Main St in the Town of Sheridan: Run thence east along the north side of 10th St a distance of ~~1534~~¹⁵³⁴ ft, thence N 45° E 66 feet, thence north in the west half of $\frac{1}{4}$ Bailey St ~~320~~⁶⁶⁰ feet, thence north 45° E 34 feet thence east 178 feet, thence north 416 feet thence north 34° 30' East 800 feet; Thence north 45° East 500 feet; thence north 66° 30' East 390 feet; thence north 59° East 645 feet; and terminating in what is known as the Geo. Symons Drain at or near the northwest corner of the East half of the Southeast quarter of section 32 Township 20 north Range 3 east in Hamilton County, Indiana.

ALSO ARM NO 1. Begin 8 feet west of the Northwest corner of lot 8 square 4 Thistlewaite 2nd Addition to Sheridan; Run thence south 66 feet and enter main Ditch at Station 0 of said main Ditch.

ALSO ARM NO 2. Begin 10 rods north and 10 rods of the intersection of 10th & Georgia Streets in Town of Sheridan Indiana; Run thence south 165 feet and enter Main Ditch at Station 3 + 33 of said Main Ditch.

ALSO ARM NO 3. Begin 40 rods south of the north line of 10th St in the West half of Georgia St in the Town of Sheridan; Run thence north 660 feet and enter Main Ditch at Station 4 + 78 of said Main Ditch.

ALSO ARM NO 4. Begin near the northwest corner of Lot No 2 Sheridan Glass Mfg. Co. Addition Sheridan. on what is known as the Geo Symons Drain and connecting thereto and run thence north a distance of 50 feet and enter Main Ditch at Station 12 + 75 of said Main Ditch.

Requirements.

Main Ditch;

Said main ditch to consist of One row of 8 inch tile from Station 0 to Station 4 + 78, One row of 12 inch tile from Station 4 + 78 to Station 13 + 75 and One row of 24 inch tile from Station 13 + 75 to 51 + 80 and an 24 inch diameter concrete flume from Station 51 + 80 to 52 + 15 or terminus, and a reinforced concrete retaining wall in accordance with plans for same at the terminus.

Also said main ditch to have concrete Catch Basins at at Station 4 + 78, 13 + 75, 22 + 60, 29 + 60, and 34.

Said basins to be 3 Feet in diameter and to have 4 inch walls, 4 inch concrete bottom and covered with grated Iron Tops of the Blwood Pattern or its equal,

The opening in the covers to be of the Capacity of the outlet tiles, except that the basin at Station 29 + 60 shall be a concrete connecting Box 3 feet by 6 feet inside measurements and the wall to be 6 inches thick, and covered with grated top made to fit the dimensions of the Box, made of Iron or a reinforced Concrete perforated slab.

Arm No 1.

Said Arm No 1, Shall consist of 1 Row of 6 inch tile from Station 0 to Station 0 + 66 and be curved into Main ditch at Station 0 of Main ditch.

Arm No 2.

Said Arm No 2, shall consist of One Row of 6 inch tile from Station 0 to Station 1 + 65 and be curved into Main Ditch and connected by means of a 6 inch by 8 inch Sewer Y Branch. at Station 3 + 33 of Main Ditch

Arm No. 3.

Said Arm No 3. shall consist of one row of 8 inch tile from Station 0 to Station 6 + 60 and connected into the Catch Basin, At Station 4 + 78 on main Ditch.

Arm No. 4.

Said Arm No 4. shall consist of one row of 8 inch tile and be connected to the Symons Ditch at 0 of said Arm, *by means of a Catch Basin* and be connected into the Catch Basin, at Station 13 + 75 on main Ditch, Said Arm being 50 feet in length, And lying across and under 10th Street in the Town of Sheridan.

CONCRETE WORK.

Unless otherwise specified all concrete work included in these specifications shall be a mixture of 1-2-5; one part Portland Cement, two parts sand, and three parts gravel.

The sand and gravel to be free from dirt, loam, and other foreign matter.

The cement, sand and gravel to be thoroughly mixed while dry until it presents an even shade of coloring throughout, then made into a moderately wet mortar, and be immediately placed in the forms for moulding the concrete into shape.

The forms for all the concrete work to be neatly constructed from strong materials, and shall be true to lines, dimensions, and shape given and in accordance with the plans hereto attached, and on file in the Surveyors Office for all the different structures.

The work will be staked out by the Engineer and his stakes must be carefully preserved and followed. The digging of each and every portion of the ditch must begin at its outlet, or its junction with another tile drain and proceed toward its upper end.

The ditch to be dug along one side of the line of survey stakes and in sufficient distance from them to not disturb them, and shall be cut in a straight and neat manner. In taking out the last draft the blade of the spade must not go deeper than the grade line.

The ditch must be dug accurately and true to grade at the depth indicated by the figures given by the Engineer, measured from the grade stakes.

The laying of the tile must begin at the lower end and proceed up stream. The tile must be laid as closely as possible and in a line free from irregular cracks, the piece being turned about until the upper closes, unless there is sand or fine silt which is likely to run into that tile, in which case the lower edge must be laid close and the upper side covered with clay or other material.

When making turns or by other unavoidable reasons a crack of one fourth inch or more is necessarily left, it must be securely covered with broken ~~xxx~~ pieces of tile, or by other indestructible materials, junctions with branch lines must be carefully and securely made. After the tile have been laid and inspected by the Engineer or his representatives, they must be covered with the earth excavated from the trench, or borrowed clay or soil, where said trench does not afford sufficient material, and in no case less than two feet in depth over the tile in new cuts.

We are of the opinion that as said ditch crosses the right of way of the Chicago, Indianapolis & Louisville Railroad Company, and that said railroad company has been assessed in the sum of \$100.00, as benefits to its right of way; that if said railroad company desires to make different construction, than that provided for in the specifications, for that portion of the ditch lying within its right of way; then and in that case the said railroad company shall have the privilege of putting/ⁱⁿ whatever construction it desires, equal to or superior to the construction provided for in these specifications, said company to place said construction across its right of way at its own expense; but should said railroad company avail itself of the privilege of putting in said construction, and does so to the satisfaction of the engineer in charge of the work, then and in that case said railroad company shall have credit on its assessment as herein fixed to the amount of \$30.00, the same being the estimated cost of construction^{of} the drain across said right of way.

And where said drain is an open channel the filling shall be a depth of not less than two feet above the top of the tile, for the full width of said channel, in no case must the tile be covered with sand without other materials being first used and in no case will boulders or heavy rock which may in time come in contact with the tile, be allowed in the trench while filling.

The ditch contractor must assume all risk from caving-in of the ditch, and when each portion of the drain is completed it must be free from sand and mud before it will be received and paid for in full.

In case it is found impracticable by reason of bad weather or other unlooked for trouble in digging the ditch or in properly laying the tile to complete the work in the time specified in the contract, the time may be extended as may be mutually agreed upon by the Contractor and the Engineer. The contractor shall use all necessary precaution to secure his work from injury while he is constructing the drain. All tile and other materials used in the construction of the drain and its tributaries thereto, included in the specifications, shall be first class in every respect and and subject to rigid inspection by the Engineer.

The Engineer shall have the authority to lay out and direct the work, and supervise the same during the construction, and completion to see that it is properly done in accordance with the specifications and contract, and his instructions shall be fully carried out.

We are of the opinion that as said ditch crosses the rightofway of the Chicago, Indianapolis & Louisville Railroad Company, and that said railroad company has been assessed in the sum of \$250.00, as benefits to its right of way; that if said railroad company desires to make different construction than that provided for in the specifications for that portion of the ditch lying within its right of way then and in that case the said railroad company shall have the privilege of putting in whatever construction it desires, equal to or superior to the construction provided for in these specifications, said company to place said construction across its right of way at its own expense; but should said railroad company avail itself of the privilege of putting in said construction, and does so to the satisfaction of the Engineer in charge of the work, then ~~and~~ and in that case said railroad company shall have credit on its assessment as herein fixed to the amount of ~~the~~ \$100.00, the same being the estimated cost of construction of the drain across said right of way.

Plan for Headwalls

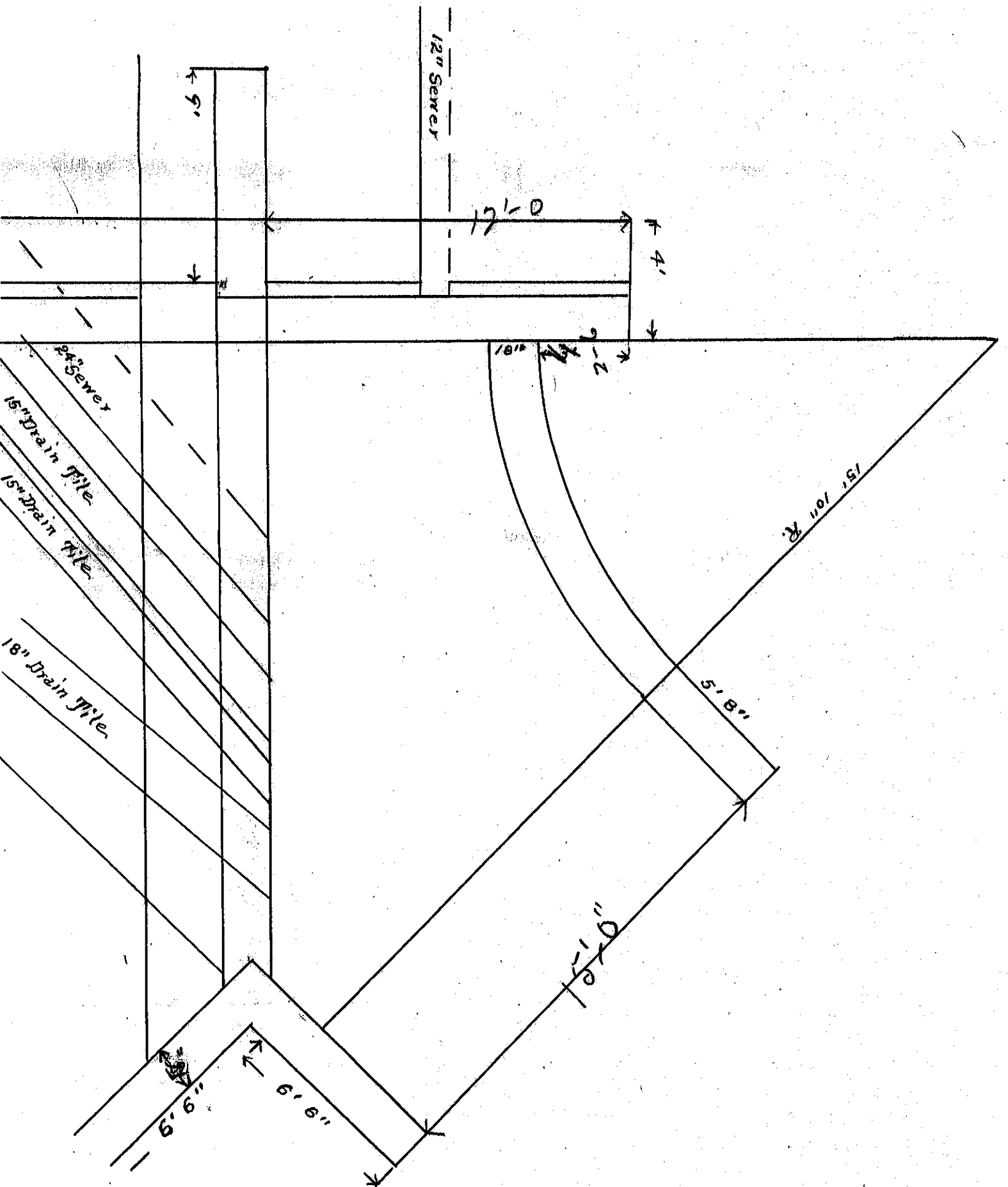

STATION HUB CUT YARDAGE.

1	11	37
2	11	37
3	11	37
4	11	37
5	11	37
6	11	37
7	11	37
8	11	37
9	11	37
10	11	37
11	11	37
12	11	37
13	11	37
14	11	37
15	11	37
16	11	37
17	11	37
18	11	37
19	11	37
20	11	37
21	11	37
22	11	37
23	11	37
24	11	37
25	11	37
26	11	37
27	11	37
28	11	37
29	11	37
30	11	37
31	11	37
32	11	37
33	11	37
34	11	37
35	11	37
36	11	37
37	11	37
38	11	37
39	11	37
40	11	37
41	11	37
42	11	37
43	11	37
44	11	37
45	11	37
46	11	37
47	11	37
48	11	37
49	11	37
50	11	37
51	11	37
52	11	37
53	11	37
54	11	37
55	11	37
56	11	37
57	11	37
58	11	37
59	11	37
60	11	37
61	11	37
62	11	37
63	11	37
64	11	37
65	11	37
66	11	37
67	11	37
68	11	37
69	11	37
70	11	37
71	11	37
72	11	37
73	11	37
74	11	37
75	11	37
76	11	37
77	11	37
78	11	37
79	11	37
80	11	37
81	11	37
82	11	37
83	11	37
84	11	37
85	11	37
86	11	37
87	11	37
88	11	37
89	11	37
90	11	37
91	11	37
92	11	37
93	11	37
94	11	37
95	11	37
96	11	37
97	11	37
98	11	37
99	11	37
100	11	37

2.988.00

STATION HUB CUT YARDAGE.

ARM No. 1		
0	6.28	
0+66	6.64	22
ARM No. 2		
0	6.30	
1	5.48	33
1+65	6.21	21
ARM No. 3		
0	3.32	
1	3.57	20
2	3.32	21
3	4.00	22
4	3.97	22
5	4.22	23
6	4.44	23
6+60	5.68	17
ARM No. 4		
0	4.93	
0+40	5.64	36

54.

148.00

Estimated cost of Construction Including,
 Material, Labor, Hauling, etc.,
 Necessary for completion of the work in
 accordance with the plans and specifications,

Main Outlet Station	0	to	524.5-
Curve No 1 Station	0	to	0.766
" " 2 Station	0	to	1.765-
" " 3 " "	0	to	6.760
" " 4 Station	0	to	2.752

Total \$6896.80

Estimated expenses, including,
 Attorneys Fee
 Recording & Releasing
 Legal Printing
 Superintendent of Construction
 Court Expenses etc.
 Contingency fund

Total \$880.00-

We claim for services, expenses & mileage, to date for

<i>Denny Larvin</i> Drainage Commissioner	26.00
<i>W. K. Stahl</i> Viewer	40.00
<i>J. H. Thomson</i> Engineer <i>Helpert & Ely</i>	135.00

Total 211.00

GRAND TOTAL \$7990.80-

(101)

NAMES	DESCRIPTION OF LANDS	Section	Township	Range	Acres Assessed		Acres Benefited		Amount of Benefits		Am't of Assessment		Total Assessment		
					A	Hun	A	Hun	\$	Cts.	\$	Cts.	\$	Cts.	
John H. Cox	Lots 60, 35, 38, 43, 41, 48, 56, S, g, mfg Co Add.									94	20	28	50		
" " "	Lots 3, 4, 5, 6, 7, 8, Sq 2, J, H, C, Add.									81	60	68	00		
" " "	Lots 7, 8, Sq 8 J, H, C Add.									26	40	22			
" " "	Lots 4, 5, 6, 7, Sq 9, J, H, C.									53	30	44		162	50
Henry Prather	Lot 1. Sq 4, This. 2nd									29	90	24	90	24	90
Vanbibber Eva B.	Lot 2. " " " "									29	90	24	90	24	90
Mamie F. Young	Lot 7. " " " "									29	90	24	90	24	90
Guy Kercheval	Lot 8. " " " "									29	90	24	90	24	90
Lewis C. Mitchell & wife	Lot 1. Sq 5, " "									20	70	17	20	17	20
Ruth M. Riggs	Lot 2. " " " "									20	70	17	20	17	20
Joseph McCray	Lot 3. " " " "									20	70	17	20	17	20
Amanda C. Krause	Lot 4. " " " "									20	70	17	20	17	20
Ellis & Mary F. Hiatt	Lot 5. " " " "									20	70	17	20	17	20
Harriett Cash	Lot 6. " " " "									20	70	17	20	17	20
Arthur Robbins	Lot 7. " " " "									20	70	17	20	17	20
Edmon O. Cook	Lot 8. " " " "									20	70	17	20	17	20
John & Theresa J. Freeman	Lot 8. Sq 6, " "									18	00	14	20	14	20
R. F. Milligan	Lot 6. " 4, " "									29	90	24	90		
Henry Rippon No.	Lot 5. " " " "									29	90	24	90	49	80
Chas P. Copeland	Lot 1. Sq 1, J.H.C. Add.									9	60	8			
" " "	Lot 2. " " " " "									9	60	8			
" " "	lot 3. " " " " "									9	60	8		24	00
Gertrude Fristoe	Lot 1, Sq 2, " " " "									14	40	12			
" " "	Lot 2. " " " " "									14	40	12		24	00
W.F. & Ella Franklin	Lots 9.10, Sq 2, " " "									38	80	24			
" " " "	Lot 9. Sq 3. J.H.C. Add.									14	40	12		36	00
Joel T. Hill	Lots 1.2.3.10. Sq 3. J.H.C. Add.									50	40	42		42	00
Harriett J. Trout	Lots 4.5. " " " " "									19	20	16		16	00
Lizzie Pearson	Lot 6. " " " " "									12	00	10		10	00
Gora Stout Smith	Lot 7. " " " " "									12	00	10		10	
John Pulliam	Lot 8. " " " " "									12	00	10		10	
														635	70

NAMES	DESCRIPTION OF LANDS	Section	TOWNSHIP	Range	Acres Assessed		Acres Benefited		Amount of Benefits		Am't of Assessment		Total Assessment	
					A	Hun	A	Hun	\$	Cts.	\$	Cts.	\$	Cts.
Emma Robbins	Lots 1.2. Sq 4. J.H.C. Add.								28	80	24	00	24	00
Carmel Merrill & wife	" 3. " " " "								12		10		10	
Mary J. Remsen	" 4. " " " "								12		10		10	
Christina Mace	" 5. " " " "								12		10		10	
C.P.&N.A. Shannon	" 8. " " " "								12		10		10	
Anna F. Johnson	" 6.7.9.10. " " "								52	80	44		44	00
W.E.&Anna J. Laughlin	" 1.2. Sq 5. " " "								26	40	22		22	00
Elihu Barker	" 3. " " " "								14	40	12		12	00
Jno G. Barker	" 4.5.6. " " " "								43	20	36		36	00
Rosa Wagner	" 7. " " " "								14	40	12		12	00
Hester E. Tinder	" 8. " " " "								12	00	10		10	00
Hattie M. Moon	" 9.10. " " " "								24	00	20		20	00
A.M.Stephenson&Wife	" 1. Sq 6. " " "								8	40	7		7	
Freemont Linton	" 2.3.4. " " " "								25	20	21		21	00
Peter O. Duncan	" 1. Sq 8. " " "								12	00	10		10	00
C. M. Parr	" 2. " " " "								12	00	10		10	00
James C. Goff	" 9. " " " "								12	00	10		10	00
Otis G. Kendell	" 10. " " " "								12	00	10		10	00
John H. Young	" 1.2. Sq 9. " " "								28	80	24		24	00
Louie Mace	" 3. " " " "								12	00	10		10	00
Dollie Coleman	" 1. A. Smith 2nd .								9	60	8		8	00
Maggie J. Harvey	" 2. " " " "								9	60	8		8	00
A. M. Padgett	" 3. " " " "								9	60	8		8	00
John & Sarah Hall	" 4.5. " " " "								17	20	16		16	00
Robert Goodner	" 6.7. " " " "								19	20	16		16	00
Clyde Robbins. Pt,	" 13. " " " "													
" "	" 14. 15. " " " "								24	00	16		20	00
Wm Carpenter & wife	" 16. " " " "								9	60	8		8	00
Chas G. Rawlings	" 17. " " " "								9	60	8		8	00
Nettie Six	" 18. " " " "								9	60	8		8	00
Irene A. Stephenson	" 19.20. " " " "								19	20	16		16	00
Virgil Robbins	" 1.2.3. Hoff Add.								2	90	2	40	2	40
Ted M. McKinney	" 4.5.21. " " "								2	90	2	40	2	40

442 00
442 80

No 3.

NAMES	DESCRIPTION OF LANDS	Section	Township	Range	Acres Assessed		Acres Benefited		Amount of Benefits		Amt of Assessment		Total Assessment		
					A	Hur	A	Hur		Cts.	\$	Cts.	\$	Cts.	
	<i>lot 7 belongs to John Wagers</i>														
Minnie McMath	Lots 6.7. Hoff. Add.								2	10		1	60	1	60
John Mutchler	" 8. " "									96		80		80	
W.H.H.Moore&wife	" 9.10.11.12.13.23.24. Hoff. Add.								6	70		5	60	5	60
Bettie Faucett	" 14. Hoff Add.									96		80		80	
Chas B. Miller	" 15. 16. 17. Hoff Add.								2	90		2	40	2	40
Ben Hoffman	" 18. 19. 20. 40 41 42. Hoff. Add.								5	80		4	80	4	80
H. E. Newman	" 22. Hoff. Add.									96		80		80	
Alice Hoffman Evans	" 38. 39. " "								2	10		1	60	1	60
Orlando Robbins & wife	" 6. Sq 1. A Smith. 1. Add.								4	80		4	00	4	00
Geo A. Tear & wife	" 1.2. Sq 2. A Smith 1. Add.								14	40	12			12	00
Levi Mikels	" 3. " " " " " "								7	20	6			6	00
Kate Stephens	" 4. " " " " " "								7	20	6			6	00
John D. Hubbart	" 5. " " " " " "								9	60	8			8	00
Julia A. Dunham	" 6. " " " " " "								9	60	8			8	00
John W. Fouch Pt	" 7. " " " " " "								8	40	7			7	00
Wm B. Pierce	" 8. " " " " " "								8	40	7			7	00
John F. &															
Edna P. Kirby Et	" 1.2. Sq 3. A. S. 1st Add.								9	60	8			8	00
Wm Agers	" 6. " " " " " "								9	60	8			8	00
Glenn Hubbart & wife	" 7. " " " " " "								9	96	8			8	00
Lynch Thos, B,	" 8. " " " " " "								9	60	8			8	00
Mary E.															
Huckleberry	92 ft, E, end Lot 7. sq 1. A. Smith 1st Add.										3				
"	92 " " " " 8. " " " " " "								7	20	3			6	00
W.F. Dunham	Lots 1.2.3.4.5.6.7.8. Sheridan Glass Mfg Co Add.								67	20	56			56	00
John & Blanch															
Pritsch	Lots 9. 28. S.G. Mfg Co. Add.								13	20	11			11	00
Carrie Mitcheal & children	" 10. " " " " " "								8	70	7			7	00
Sam Griffin	" 15.20.21. " " " "								18	00	15			15	00
Ida M.Morris & husband	" 29.36.37.44. " " " "								16	80	14			14	00
C.E. Elliott	" 45. " " " " " "								3	60	3			3	00
A.O.&Elvin Scott	" 52. 53. " " " " " "								7	20	6			6	00
Nancy M. Harris	" 61. " " " " " "								2	40	2			2	00
Wray Burlington & wife	" 68. 54. 59. " " " "								8	40	7			7	00
									<i>235.40</i>			<i>235.40</i>			

NAMES	DESCRIPTION OF LANDS	Section	Township	Range	Acres Assessed		Acres Benefited		Amount of Benefits		Am't of Assessment		Total Assessment		
					A	Hun	A	Hun	\$	Cts.	\$	Cts.	\$	Cts.	
F. Thurman & Wife	Lots 75.63.69.76.76+														
	77.62.67.70. S. G. Mfg Co. Add.									21	18	00	18	00	
Delilah J. Math	Lot 11. " " " "									8	40	3	7	00	
J. M. Glenn	" 14. " " " "									8	40	7	7	00	
Wm R. Madison	" 19. 22. " " " "									9	60	8	8	00	
Peter Glenn & wife	" 27.30.12.13.26.31. " " " "									36	00	90	30	00	
Albert McCarty	" 46. " " " "									3	60	3	3	00	
Seth Hinshaw	" 51.39.42.47.50.55. " " " "									18	00	15	15	00	
Harry H. Griffin	" 18. " " " "									4	80	4	4	00	
Geo H. Palmer	" 34. " " " "									4	80	4	4	00	
Geo R. & Della A. Royer	" 58. " " " "									2	40	2	2	00	
W. H. Smith	" 49. " " " "									2	40	2	2	00	
Andrew L. Hatlinger	" 40 " " " "									2	40	2	2	00	
William D. McCoskey	" 17. 24. 25. 32. 33. " " " "									21	60	18	18	00	
Standard Oil Co.	" 16 = to 4 Lots " " " "									33	60	28	28	00	
J. G. Antrim	" 23. S. G. Mfg Co. Add.									4	80	4	4	00	
" " "	" 25.26.27.28.29.30. Hoff " "									5	75	4	80		
" " "	" 31.32.33.43.44.45.46. Hoff " "									6	90	5	60	14	40
John M. Haines	40ft W end 7. Sq 1. A. Smith 1st Add.									1	80	1	50		
" " "	40ft " " 8. " " " " " "									1	80	1	50	3	00
Chas F. Kirby	Lot 5. Sq 1. A. Smith 1st Add.									4	80	4	4	00	
Eunice Anna Reagan & Marie Reagan Perry	Lot 10 Sq 3. S Y O. 3rd Add.									4	80	4	4	00	
Marie Reagan Perry	" 11. " " " " " " " "									4	80	4	4	00	
Claudius Goff	" 9. " " " " " " " "									4	80	4	4	00	
Wm J. Eberwine & wife	" 8. " " " " " " " "									4	80	4	4	00	
Willis H. Bohanan	" 6. " " " " " " " "									4	80	4	4	00	
Jacob Pritsch	" 7. " " " " " " " "									4	80	4	4	00	
Florence Stokes	" 6. Sq 2. White Add.									3	60	3			
" "	" 7. " " " " " " " "									3	60	3	6	00	

199 40 / 199 40

NAMES	DESCRIPTION OF LANDS	Section	Township	Range	Acres Assessed		Acres Benefited		Amount of Benefits		Am't of Assessment		Total Assessment	
					A	Hun	A	Hun	\$	Cts.	\$	Cts.	\$	Cts.
Ora A. Harvey <i>OK</i>	Pt W $\frac{1}{4}$ S E 32 20 3 Begin 106.2 $\frac{1}{3}$ rds W of the SE cor of said $\frac{1}{4}$ Sec Run N 160 rds; Thence W 53.1 $\frac{1}{3}$ rods; Thence S to the Lafayette road; thence down the center of said road to the S line of said Sec; Thence E to place of beginning. Also a part of the Se $\frac{1}{4}$ Section	32	20	3										
	Begin 53.1 $\frac{1}{3}$ rds W & 57.87 rds N of the Se cor of said $\frac{1}{4}$ Sec Run thence N 102.13 Rds; Thence W 53.1 $\frac{1}{3}$ rods; Thence S 102.13 rods; Thence E to place of beginning	32	20	3										
					44	50	44	50	320	40	267	00		
Jesse L. Harvey <i>OK</i>	Pt W. S.E. 32 20 3 Begin 53 1/3 rds W of SE cor 32-20-3; Run W 53.1/3 rds N to a point directly E of the center of 7th St. in the town of Sheridan; Thence E 53.1/3; Thence to place of beginning	32	20	3										
									19	30	72	00	60	60
<i>Norma Fesmire</i> J. J. Johnson <i>OK</i>	Pt E. SE $\frac{1}{4}$ 32 20 3 53 1/3 Acres off of the E side of the SE $\frac{1}{4}$ of Sec 32-20-3 except 13 A. out of the SE cor thereof, owned by Chas H. Lambert. Also begin at the SE cor of Sec 32-20-3 and go N 104 rds; W 20 rds; S 104 rds; E 20 rds to place of beginning	32	20	3										
					13		4		12	00	10		10	00
Anderson Collier <i>OK</i>	Pt E $\frac{1}{4}$ SE 32 20 3 Begin 20 rds W of Se cor of said Sec; Run W 33 1/3 rds; Thence N 160 rds; Thence E 53 1/3 rds; Thence S 56 rds Thence W 20 rds; Thence S 104 rds; to place of Beginning. 40.1/3 A.	32	20	3										
					40	35	13		34	60	20	50	20	00
Frank Darnell <i>OK</i>	Pt NE NE 5 19 3 Begin at NE cor, Sec 5 Run thence W 719 ft; S 400 ft; thence E 719 ft; Thence N 400 ft; to place of beginning	5	19	3										
					6	6	6		12	00	10	00	10	00
Alva Boone <i>OK</i>	SW SW SW SW 33 20 3	33	20	3										
					2	25	1		3	60	3		3	00

106

NAMES	DESCRIPTION OF LANDS	Section	Township	Range	Acres Assessed		Acres Benefited		Amount of Benefits		Am't of Assessment		Total Assessment	
					A	Hun	A	Hun	\$	Cts.	\$	Cts.	\$	Cts.
Chicago, Indianapolis, Louisville R. R.	NE NW 1/4	5	19	3										
" " "	Pt SW	32	20	3										
Begining that portion of said Right of Way lying in the	NE NW	5	19	3										
and in the	SW 1/4	32	20	3										
and extending from the E line of Georgia St. in the town of Sheridan Ind. to the line dividing the	NE 1/4 NW 1/4	5	19	3					300 00	250 00	250 00			
J. R. Ogle OK	16 A. off N end W 1/2													
	NW NW	5	19	3			16		182 40	152	152 00			
Blanch Pritsch OK	Pt E NW	5	19	3										
	Begin at the NW cor lot 3 G & Mfg Add, to town of Sheridan, Ind, Run Thence W to NE cor Lot 20 in A Smith 2nd Add to the town of Sheridan, Ind. Thence S 80 rds; Thence E to a point directly S to place of begining, Thence North to place of begining							10	174 00	145 00	145 00			
Dave W Norman OK	NW NW	5	19	3										
	6 Acers off E end of 9. 58 Acers off S side							6	72 00	60	60 00			
Samuel Barker OK	NE SW NW	5	19	3	10		6		64 80	54	54 00			
Sheridan Packing Co.	NE 1/4 NW 1/4	5	19	3										
	4. 3/4 Acers of N end Begin on the 1/2 Sec line between the NE & NW 1/4 of Sec 5-19-3 at the S line of the Right of Way of the Chicago, Indianapolis Louisville, R.R. Run S 45.7 rds; W 21 rds 9 links; N 63 rds 1 link; to said S line of Right of Way Thence SE along said line of Right of Way 28 rds 8 links to place of begining.							4 75	72 00	60	60 00			
Wm H. Compton OK	W 1/2 NE	5	19	3										
	20 A off N end W 1/2 NE except that portion of same lying N of the Lafayette Road						18	14	30 40	42	42 00			

763 763

NAMES	DESCRIPTION OF LANDS	Section	Township	Range	Acres Assessed		Acres Benefited		Amount of Benefits		Am't of Assessment		Total Assessment	
					A	Hun	A	Hun	\$	Cts.	\$	Cts.	\$	Cts.
Clarence Fox <i>OK</i>	<i>SW SE</i> Pt SW SW SW Begin 33 rds 19 links E of the SW cor of said 1/4 Sec; Run N 24 rds 8 links Thence SE along the center of Lafayette Road 40 rds to S line of said Sec Thence W 32 rds to Beginning	32	20	3	1	50	2	40	19	20	16		16	00
<i>Hannah M Jones</i> <i>OK</i>	<i>SW</i> Pt 1/2 1/2 NE NW lying N of 5th St & E of Bailey St	32	20	3			25	25	7	20	6		6	00
Ralph S. Royster <i>OK</i>	Pt 1/2 NE NW lying E of Lafayette Road, & S of 5th St.	32	20	3			25	25	7	20	6		6	00
Wm F. Cox & Wife <i>OK</i>	Pt 1/2 NE NW lying S of 5th St & W of Bailey St.	32	20	3			33	33	7	20	7		7	00
M. A. Eberwine <i>OK</i>	Pt 1/2 NE NW lying S of 5th St & E of Baily St.	32	20	3			66	66	9	60	8		8	00
Malinda Owen <i>OK</i>	<i>SW</i> Pt 1/2 NE NW lying S of 4th St & E of Bailey St. Also Pt lot 1. Sq 3. White Add.	32	20	3			20	20	6	00	5		7	50
Squire Owens	<i>SW</i> Pt 1/2 NE NW S of 4th St & E of Land Deeded to Malinda Owen, John P. Jack, & M. A. Eberwine.	32	20	3			2	2	30	00	25	00	25	00
Arza Smith <i>OK</i>	<i>SW</i> Pt N 1/2 N 1/2 SE NW Lying between 6th & 7th E of St John St, & W of White Ave.	32	20	3			2	63	93	60	78	00	78	00
<i>Little Kincaid</i> <i>OK</i> Lindsay P. Owen	Pt Lot 1. Sq 3. White Add.								6	00	5		5	00
Geo Symonds <i>OK</i>	1/2 NW NW except that part sold to J.W. Selby, by Deed, Recorded in Deed Record 57, Page 454. lots 8,9,10,11,12. 8ft off S side of 13 A. Smith Add.	5	19	3			15	80	15	80	224	10	224	10
Farmers Coop Co,	Begin at a point 20, rds N of the SW cor of the SE 1/4 of the SW 1/4 of Sec 32 Tp 20, R 3 E, Run E 9 1/2 rds N to the R of W, of C.I. & L.R.R. co NW parallel with said R of W to a point directly N of the place of beginning. Thence S to the place of beginning. Begin 25 1/2 rds N of S line Run W 10 1/2 rds N to 8st, E to R of W of C.I. L.R.R SE along said R of W to 1/8 Sec line, Thence S to place of beginning containing 3/4 Acre	32	20	3					180	00	150	00	150	00

No 5

NAMES	DESCRIPTION OF LANDS	Section	Township	Range	Acres Assessed		Acres Benefited		Amount of Benefits		Am't of Assessment		Total Assessment	
					A	Hun	A	Hun	\$	Cts.	\$	Cts.	\$	Cts.
Statia A. Stout & wife ^{OK}	lot 7, Sq 4. This 2nd add. Also begin at a cor of Georgia & Tenth St in Sheridan, Hamilton Co, Ind. where the two intersect and run thence N 198 ft, E 264 ft, S 198 ft, W 264 ft, to the place of begining.								18	00	14	20		
Joseph L. Vickery ^{OK}	W 1/2 lots 1 & 2 Sq 3 A Smith 1st Add, Also begin at the SW cor of Sheridan, Park Add, to the town of Sheridan, And go Thence E 9 1/2 rds, S 135 ft, NW along said R of W, to place of begining.								6	00	5			
Januel Griffin ^{OK} Geo & Porter Rader	Pt SW SW 32 20 3 Begin at a point 3 rds E of the NE cor of lot 8, Sq 6, Ed Thist 2nd Add. to Sheridan, And go E 8 rds, N 4 1/2 rds W 8 rds, S 4 1/2 rds to begining.								7	20	6			36
" " "	Pt SW SW 32 20 3 Also begin at a point 14 1/2 rds N of the SE cor of the SW 1/4 32, 20, 3, and go N 11 rds W 18 1/2 rds, S 11 rds, E 18 1/2 rds to place of begining.								36	00	30			36
Jacob L. Commons & wife ^{OK}	Pt SW SE 1/4 32 20 3 Begin at the SW cor of the SE 1/4 of Sec 32, 20, 3, And run E 12 rds 16 2/3 links; Thence N 12 rds 16 2/3 links Thence W 16 2/3 links Thence S to place of begining Containing One Acre.								8	40	7			
" " "	Lots 1.2.3.4. Sq 7. J.H.C. Add.								33	60	28	00		36
Harlan H Newby & wife Orval Cox ^{OK}	Pt SE SW 32 20 3 Begin at the SW cor of the SE 1/4 of the SW 1/4 of Sec 32, 20, 3, go E 5 1/2 rds, N 8 rds, W 5 rds, S to place of begining.								13	20	11			
" " "	Pt SE SW 32 20 3 Also begin 9 rds N of the SW cor of SE 1/4 Of SW 1/4 of Sec 32, 20, 3, and go N 4 rds, E 5 1/2 rds, S 4 rds, W 5 1/2 rds to place of begining.								6	60	5	50		16
James McKinzie & wife	pt SE SW 32 20 3 Begin at a point 9 1/2 rds E of the SW cor of the SE 1/4 of the SW 1/4 of Sec 32, 20, 3, and go N 9 rds, E 8 rds S 9 rds W 8 rds to place of begining.								21	60	18			18
(See)														202
														202

NAMES	DESCRIPTION OF LANDS	Section	Township	Range	Acres Assessed		Acres Benefited		Amount of Benefits		Am't of Assessment		Total Assessment	
					A	Hun	A	Hun	\$	Cts.	\$	Cts.	\$	Cts.
Floy S. Spencer <i>OK</i>	Pt NE SW Begin at the SE cor of the NE $\frac{1}{4}$ of the SW $\frac{1}{4}$ 32, 20, 3, and go N 6 rds 14 feet, Thence W to the middle of the Lafayette Road, Thence with the middle of said road SE to the S line of said NE $\frac{1}{4}$, Thence E to the place of beginning.	32	20	3					24	00	20		20	00
Emma Glover <i>OK</i>	Pt SE SW Begin at a point 21 $\frac{1}{2}$ rds E, 9 rds N, of the SW cor of the SE $\frac{1}{4}$ of the SW $\frac{1}{4}$ of Sec 32, 20, 3, and go N 50 ft, W 148 $\frac{1}{2}$ ft, and S 50 ft, E 148 $\frac{1}{2}$ ft, to place of beginning.	32	20	3					10	80	9	00	9	00
Robert C. Kercheval <i>OK</i>	Pt SW SE Begin at a point 856 ft N of the SW cor of the SE $\frac{1}{4}$ 32, 20, 3, and go S, to the center of St, as shown on J.H.C. Add. to the town of Sheridan Ind, Thence E to the Adams Tp, gravel Road, thence NW parallel with the W line of said Road, to a place directly E of the place of beginning, Thence W to the place of beginning.	32	20	3					14	40	12		12	00
M. R. Hodson <i>(See)</i>	Pt SW SE Begin at a point 18 rds E of the SW cor of the SE $\frac{1}{4}$ of Sec 32, 20, 3, Run N 13 rds, E 5 rds, S 13 rds, W 5 rds, to place of beginning.	32	20	3					7	20	6		6	00
Moline Plow Co., Inc. <i>OK</i>	Pt SW SW Begin at a point 3 rds E and 9 rds N of the NE cor of lot No. 8 Sq 6, in Ed Thist 2nd Add, to Sheridan Ind, Run E 8 rds N 6 rds to the S line of a St running E & W on the S side of Thist 1st Add. to Sheridan Ind, Thence W 8 rds to E St, Thence S 6 rds to place of beginning.	32	20	3					8	10	6	75	6	75
Iona & Dollie Scott <i>OK</i>	Pt SW SE Begin 13 rds E of the SW cor, of the SW $\frac{1}{4}$ of the SE $\frac{1}{4}$ of Sec 32, 20, 3, and Run N 13 rds E, 135 ft, Thence S 13 rds, Thence W 135 ft, to place of beginning except begin 18 rds and 10 ft E of the SW cor of the SE $\frac{1}{4}$ of said Sec and run N 13 rds, E 5 rds, S 13 rds, W 5 rds to the place of beginning.	32	20	3										

NAMES	DESCRIPTION OF LANDS	Section	Township	Range	Acres Assessed		Acres Benefited		Amount of Benefits		Am't of Assessment		Total Assessment	
					A	Hun	A	Hun	\$	Cts.	\$	Cts.	\$	Cts.
<i>Harlan</i> D. Newby <i>wife</i> <i>OK</i>	Pt SW $\frac{1}{4}$ Begin 5 $\frac{1}{2}$ rds E of the SW cor of the SE $\frac{1}{4}$ of the SW $\frac{1}{4}$ of Sec 32, 20, 3, and go E 4 rds N 13 rds W 4 rds S 13 rds, to place of beginning. Also beginning at a point 13 rds N of the SW cor of SE $\frac{1}{4}$ of SW, Run E 9 $\frac{1}{2}$ rds N 7 rds, W 9 $\frac{1}{2}$ rds S 7 rds to begin, Con 66 $\frac{1}{2}$ Sq rd.	32	20	3					41	40	34	50	34	50
Nancy Starks <i>OK</i>	Pt E $\frac{1}{2}$ NW Begin 80 rds S of S. G. Mfg. Co. Add, to the town of Sheridan, Run W 20 rds, to 1/8 Sec line, Thence S 48 rds, Thence E 20 rds, Thence N 48 rds to place of beginning, Con, 6 Acres.	5	19	3					57	60	48		48	00
<i>Wm Johnson</i> Charles Johnson	Pt NE SE SW Begin at the NE cor SE $\frac{1}{4}$ of the SW $\frac{1}{4}$ Sec 32, 20, 3, Run W to within 10ft of the Symons Ditch, Thence SW Parallel with said Ditch to Gravel Road; Thence down center line of said road to $\frac{1}{2}$ Sec line; Thence N to place of beginning.	32	20	3					36	00	30		30	00
Lizzie Horton <i>OK</i>	Begin at the Sw cor of SW $\frac{1}{4}$ of the SE $\frac{1}{4}$ of Sec 32, 20, 3, And run N 556 ft, as a point of beginning, Thence N to the center of 8 $\frac{1}{2}$ in John H. Cox Add, to Sheridan Ind. E to Adams Tp Gravel Road, SE along said Road to a point Due E of the point of beginning, Thence W to beginning. Also begin 12.2 rds 16 $\frac{2}{3}$ links N of the SW cor, of the SE $\frac{1}{4}$ of said Sec 32, 20, 3, And run E 390 ft, N 170 ft, NW along Adams Tp Gravel Road 228 ft, W 240 ft, S 350 ft to place of beginning.	32	20	3					30	00	25		25	00
W. S. Mc Murtry <i>OK</i>	Lot 6 J.H.C. Add. Sq 8. Begin at the NE cor of the SW $\frac{1}{4}$ of Sec 5 19 3 and Run Thence W to the R of W of C.I.L. R.R. Thence SE to a point directly S of the place of beginning, Thence N to the place of beginning.	5	19	3					14	40	12			
<i>Jacob C. Parr</i> <i>Ada Richardson</i> <i>Thru, 2,</i>	<i>Begin 49$\frac{1}{2}$ South of SE Cor.</i> Lot No 10, S.Y.O. 3rd Add. Run thence S to E line of White Ave, Thence N Westerly to S side 5th St, Thence E to place of beginning.								21	00	17	50	29	50
<i>R. C. Cox</i> <i>Catherine Overholser</i>	Lot No 10, S.Y.O. 3rd Add. Run thence S to E line of White Ave, Thence N Westerly to S side 5th St, Thence E to place of beginning.								6	00	5		5	00
Lee Stella Hawkins <i>OK</i>	Lots 3 & 4 Sq 8, J.H.C. Add.								25	20	21		21	00
<i>Lee Stella Hawkins</i> H. T. Hodson	Lot 5. Sq 8, J.H.C. Add.								14	40	12		12	00
Hannah A. Kendall <i>OK</i>	Lot 5. Sq 3. A Smith 1st Add. " 6. Sq 3. " " " " " "								9	60	8			
<i>13$\frac{1}{2}$ S. J.</i> <i>pt</i>									2	40	2		10	00
									215				215	00

11012

NAMES	DESCRIPTION OF LANDS	Section	Township	Range	Acres Assessed		Acres Benefited		Amount of Benefits		Am't of Assessment		Total Assessment	
					A	Hun	A	Hun	\$	Cts.	\$	Cts.	\$	Cts.
Ind. Condensed Milk Co.	<p>ok</p> <p>Pt SW SE$\frac{1}{4}$ SW$\frac{1}{4}$</p> <p>Begin 21$\frac{1}{2}$ rds E and 12 rds and 6 inches N of the SE cor of the SE$\frac{1}{4}$ of the SW$\frac{1}{4}$ of Sec 32, 20, 3, Run W 9 rds, N to the R of W of the C.I.L. R.R. Thence SE Parallel with said R of W to a point directly N of said R of W, Thence S to the place of beginning, Also begin 21$\frac{1}{2}$ rds E of the SW cor of the SW$\frac{1}{4}$ of the SW$\frac{1}{4}$ of Sec 32, 20, 3, And Run E to the R of W of C.I.L. R.R. Thence NW parallel with said R of W, to a point directly N of the place of beginning, Thence S to the place of beginning.</p>	32	20	3										
Adams Town ship	Ben to Lafayette Road,									60	00	50		
	" " Cicero Concrete Road,									60	00	50	100	
Town of Sheridan	Ben to Streets & Alleys									48000	400	400	4224	4224
<i>Total Assessments</i>														\$ 799085

5867

PAID

RECEIVED FOR RECORD

The 30th of Sept

A. D. 1929 at 11 o'clock A. M., and

Present in presence of

Carrie Canell

Recorder Hamilton County

STATE OF INDIANA ()
HAMILTON COUNTY () SS

We the undersigned viewers and Engineer,
to whom was referred the above entitled petition for
report, after being duly sworn upon oath say that we have
personally examined the whole line of said proposed ditch,
that the assessments herein made and reported are correct,
just and equitable to all parties here in named as interested,
that no other lands will be benefitted or injured by said
proposed drain, and that the above and foregoing report is
true in substance and in fact as we verily believe.

Kenneth Gwin
.....
Municipal Commissioner

M. H. Stahl
.....
Viewer

J. B. Hamon
.....
Engineer

Subscribed and sworn to before me this *16th* day of *July*, 1920.

Clark J. Hill
.....
Clerk Auditor of Hamilton County.